

Cutting and installation of mitered corners on Artisan® Lap siding and Artisan® Siding with Lock Joint System

Installation Supplement **04**

Scope: This Installation Supplement illustrates and offers guidance for the cutting and installation of mitered corners on Artisan® Lap and Artisan® Lock Joint siding products. The guidance in this document is for illustration purposes only. James Hardie does not warrant product installation or against water infiltration. The professionals associated with a project (e.g. installer, builder, architect) are responsible for designing and installing appropriate water management controls.

The guidance given herein have been prepared and presented in the simplest form to create a mitered corner with minimum saw adjustments. There are additional techniques/steps not presented here that may be utilized to create mitered corners.

Wall Preparation

- Ensure corners are level and plumb
- As a best practice for water management, install a corner flashing extending 3" - 6" from each direction over a water resistive barrier (Figure 1)
- For Artisan Lap only install a 1 1/4 in starter strip such that the ends stop at the corner of the wall. Do not overlap the ends (Figure 2)



Figure 1. Metal corner flashing applied to external corner

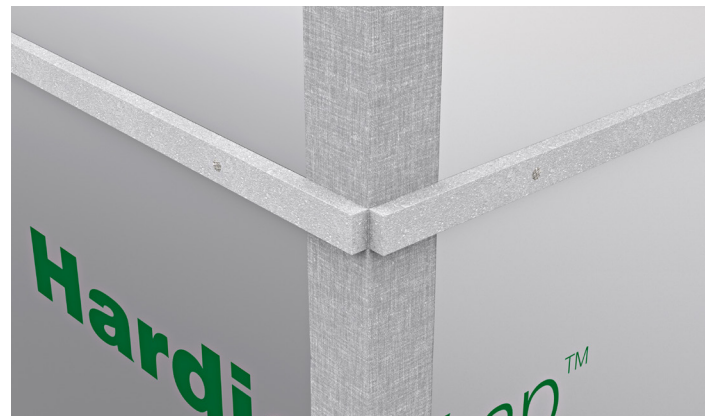

Figure 2. Starter strip (Artisan Lap only).

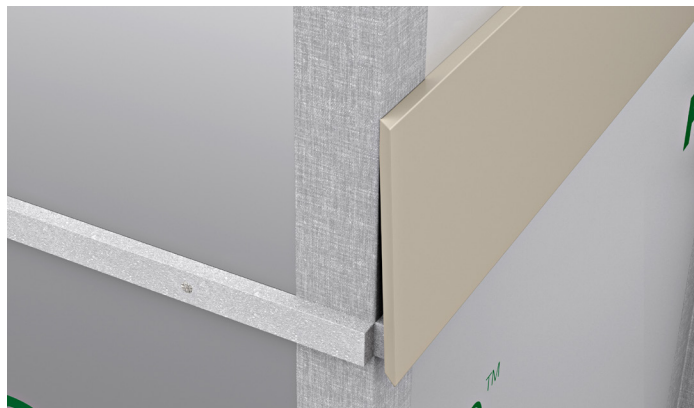

Figure 3. Applying the first Artisan Lap plank.

Cutting Preparation

- A compound miter saw (Figure 4) will be needed to cut mitered corners on Artisan Lap siding
- Use a HardieBlade® saw blade for cutting fiber cement products , along with appropriate dust collection system for OSHA compliance.
- Set saw blade - left tilt to 45° (Figure 5)



Figure 4. Compound miter saw.

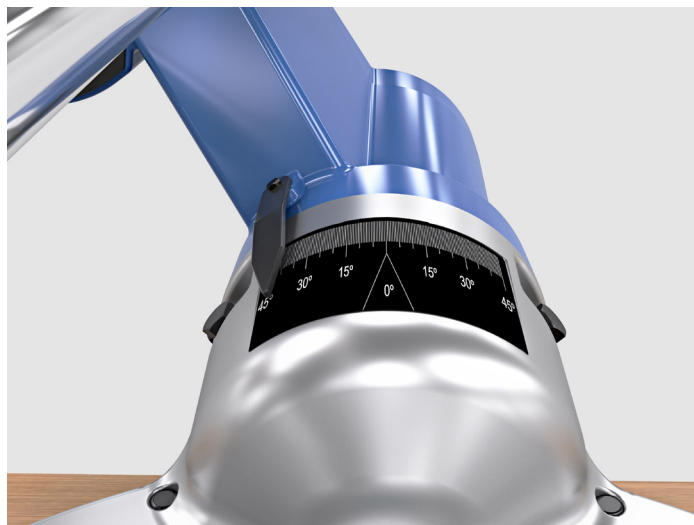

Figure 5. Set the saw blade angle to 45°.

Note: Saw setting(s) may have to be adjusted to obtain the desired miter cut aesthetics on walls that are not plumb, not level or out of square.

Artisan Lap® mitered cutting

Saw Setup

- Set saw blade - left tilt to 45° (Figure 5)
- Set saw base left of zero:
 - 10° for 5-1/4" Artisan lap
 - 8° for 7-1/4" Artisan lap
 - 7° for 8-1/4" Artisan lap

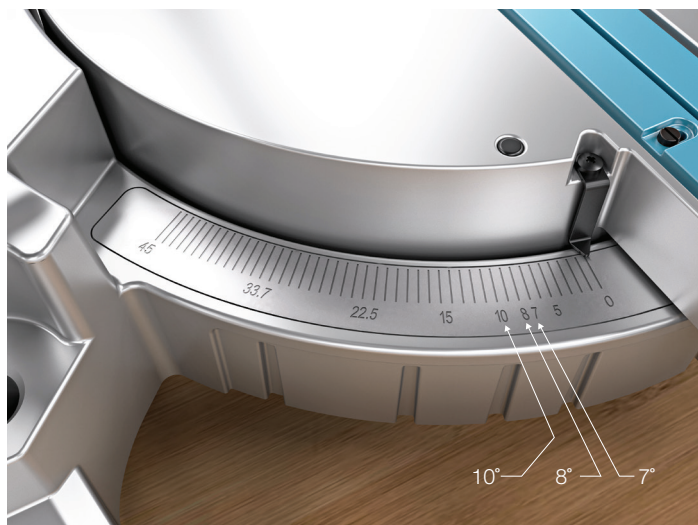

Figure 6. Set the saw base to the required setting based on plank width, as described above.

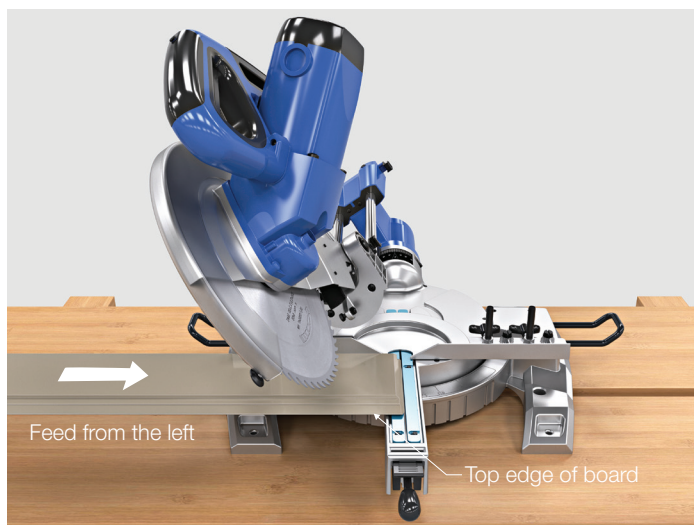

Figure 7. Left-hand miter = Feed board face down with top edge away from fence.

Outside Corners

Left - hand miter:

- Feed from the left. Place the board face down with top edge away from saw fence (Figure 7).

Right - hand miter:

- Feed from the right. Place the board face up with the top edge against saw fence.

Inside Corners

Left - handed miter:

- Feed from the left. Place the board face up with top edge away from the saw fence.

Right - handed miter:

- Feed from the right. Place the board face down with the top edge closest to the saw fence.



Figure 8. Artisan Lap siding installation with mitered internal and external corners.

Mitered corners for Artisan® siding with Lock Joint System

Saw Setup

- Set saw blade - left tilt to 45° (Figure 9)
- Set saw base at zero (Figure 10)



Figure 9. Left-hand miter = Feed board plank face down with top edge away from fence.

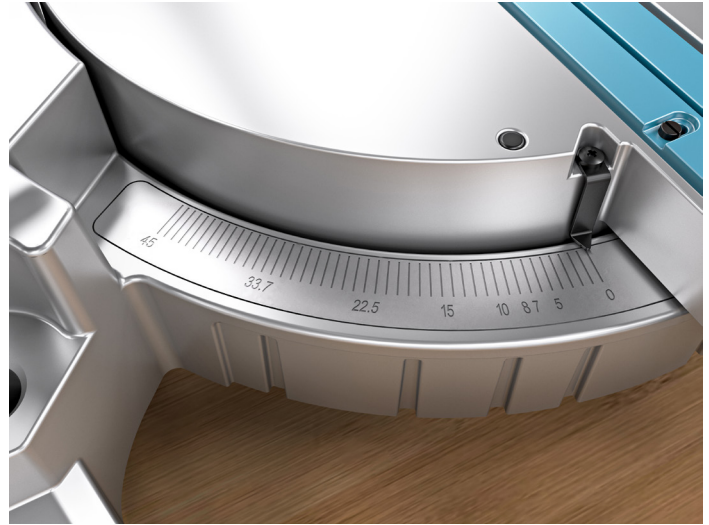

Figure 10. Set the saw base to zero.

Outside Corners

Left - hand miter:

- Feed from the left. Place the board face down with top edge away from saw fence.

Right - hand miter:

- Feeding from the left. Place the board face down with top edge against saw fence.

Inside Corners

Left - hand miter:

- Feed from the left. Place the board face up with top edge against the saw fence.

Right - hand miter:

- Feeding from the left. Place the board face up with top edge away saw fence.



Figure 11. Mitered internal and external corners for Artisan siding with Lock Joint system.

Finishing

- Fill mitered joint with sealant/glue to fill the each joint. Wipe any excess away.
- Finish nails placed minimum 1" from bottom and minimum 3/4" from miter edge can be used if needed to pull mitered corners together.
- De-burr and shape edges as necessary.
- Paint per product installation requirements.

Alternative to Miter Corners

- Aluminum corner caps (provided by others) can be used instead of a miter cut corner. The cap covers the gap formed by square cut planks at the corner, and provides a similiar appearance to a true miter cut corner.



Product warranties, safety information and additional installation information are available at jameshardiepros.com

1 866 442 7343 | www.jameshardie.com

IMPORTANT: Failure to follow James Hardie written installation instructions and comply with applicable building codes may violate local laws, affect building envelope performance and may affect warranty coverage. Failure to comply with all health and safety regulations when cutting and installing this product may result in personal injury.

DESIGN ADVICE: Any information or assistance provided by James Hardie in relation to specific projects must be approved by the relevant specialists engaged for the project (eg. builder, architect or engineer). James Hardie will not be responsible for the use of any such information or assistance.

© 2018 James Hardie Building Products Inc. All rights reserved. TM, SM, and © denote trademarks or registered trademarks of James Hardie Technology Limited. The International Building Code and International Residential Code trademarks are registered trademarks of International Code Council, Inc.